

- 30mm BACK PLATE R01SE0495 (C/FIBRE) R01SE0496 (GRP) 60mm BACK PLATE R01SE0497 (C/FIBRE) R01SE0498 (GRP) 90mm BACK PLATE R01SE0542 (C/FIBRE) R01SE0543 (GRP)

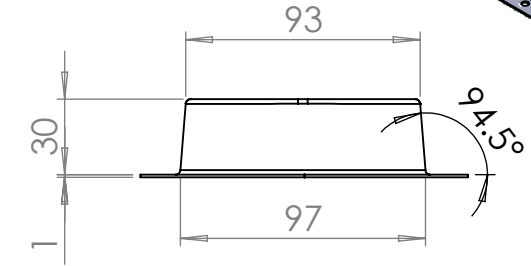

60mm BACK PLATE  
R01SE0497 (C/FIBRE)  
R01SE0498 (GRP)  
VOLUME 2.2L

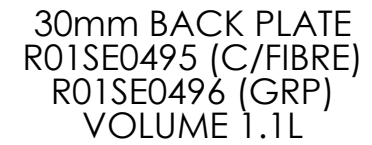
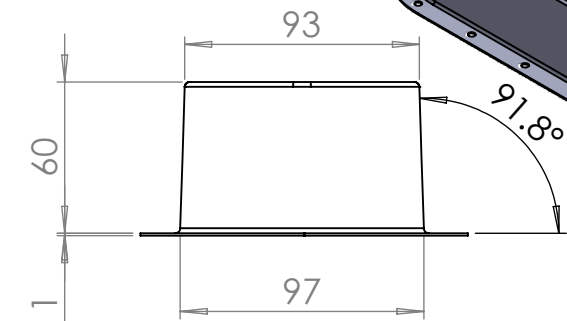

90mm BACK PLATE  
R01SE0542 (C/FIBRE)  
R01SE0543 (GRP)  
VOLUME 2.8L

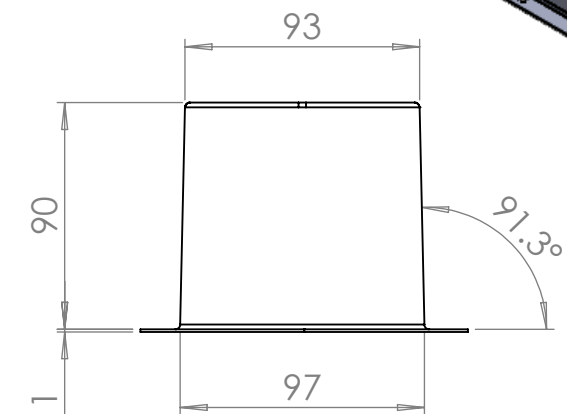

# SECTION A-A

ISS: DESCRIPTION:		INITIALS:	E.C.N. NO:	DATE:	ALL DIMENSIONS IN MILLIMETERS			
1	Original issue	SV		30/05/2012	TOLERANCES (AT 20°C) UNLESS OTHERWISE STATED			
2	Changed draft angle	BM		16/03/2015	NOMINAL LINEAR DIMENSIONS			SURFACE FINISHES:
					OVER-INCL	< 0.00	0.00	MILLING N8 TURNING N7 GRINDING N6
					0-200	+/- 0.50	+/- 0.15	
					250-1000	+/- 1.00	+/- 0.20	
					1000 PLUS	+/- 2.00	+/- 0.30	ANG DIMS

REMOVE ALL BURRS AND SHARP EDGES UNLESS OTHERWISE STATED

HOLES TO BS4500 1985.

THREADS TO BS3643 1981 METRIC COURSE.

BSP THREADS TO BS 2779 MED FIT

THIS A DRAWING IS A PRIVATE AND CONFIDENTIAL COMMUNICATION

# REVERIE

Reverie Ltd  
Unit 2 Chandlers Row  
Colchester  
Essex  
CO1 2HG  
01206 866663  
[www.reverie.ltd.uk](http://www.reverie.ltd.uk)

<b>DRAWN:</b> JC	<b>APP:</b>
<b>DATE:</b> 14/03/2018	
<b>FINISH:</b> POLISHED	
<b>SCALE:</b> DO NOT SCALE	
<b>WEIGHT:</b> -	

<b>PART NO(S):</b> R01SE0495, R01SE0496, R01SE0497, R01SE0498, R01SE0542, R01SE0543	
<b>TITLE:</b> ZOLDER 65X BACK PLATE 30/60/90mm	
<b>CUSTOMER:</b> N/A	
<b>MATERIAL:</b> SEE SHEET	
<b>INSPECTION GRADE:</b> A-1	<b>PART QUALITY:</b> B
<b>DRG. NO.:</b> SEE PART NO.S	

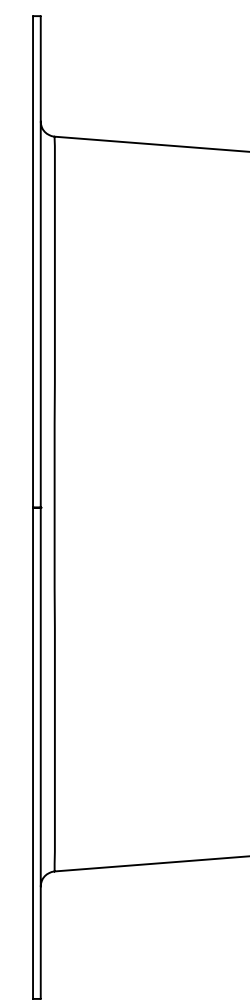
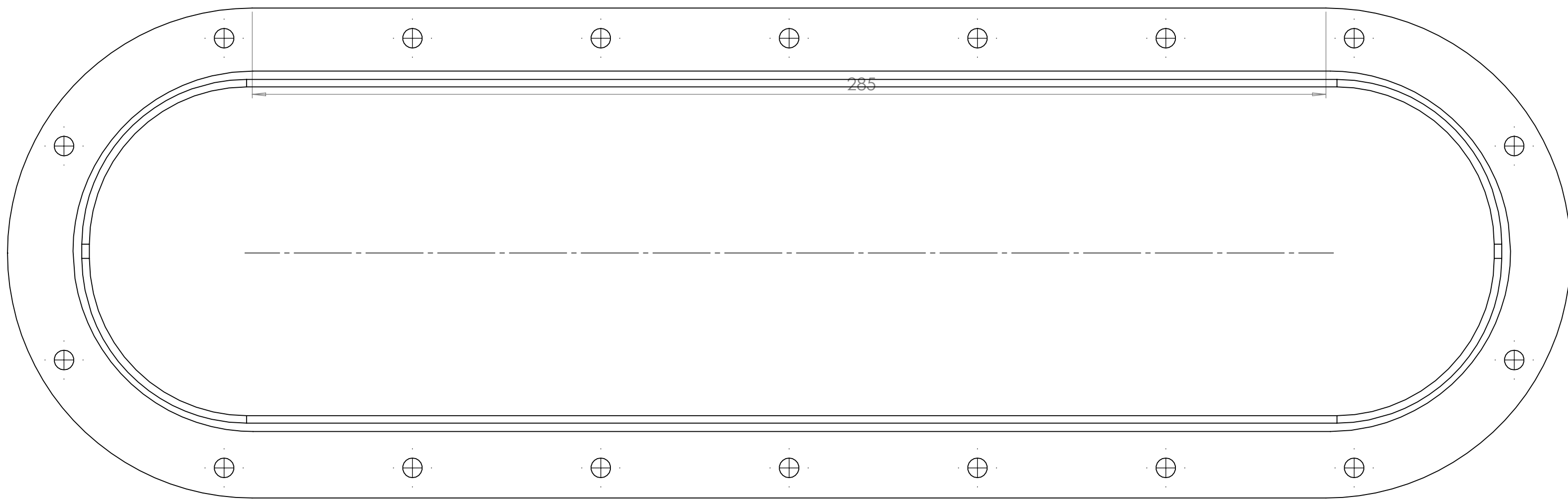
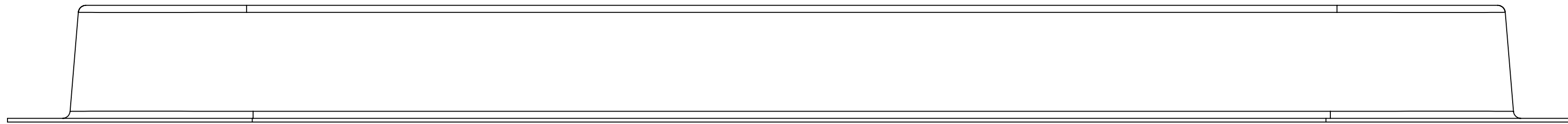

**R01SE0495/R01SE0496**

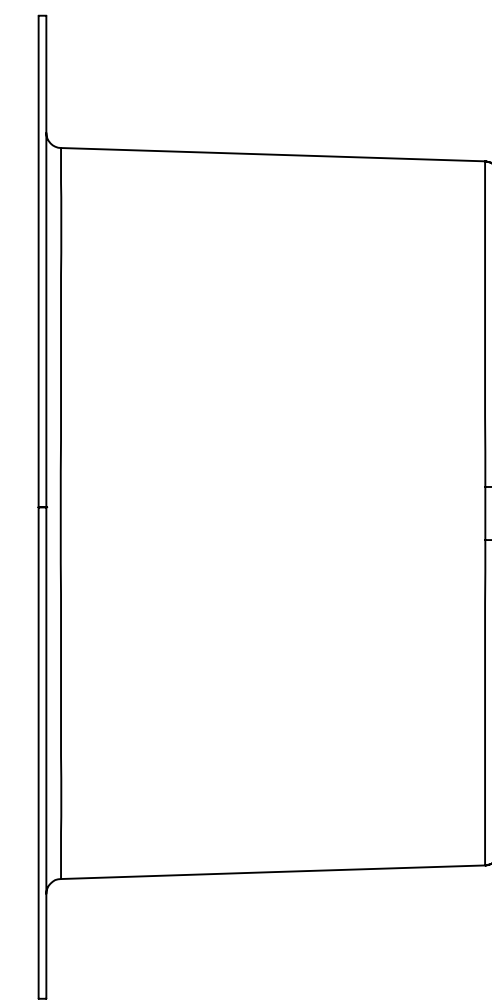
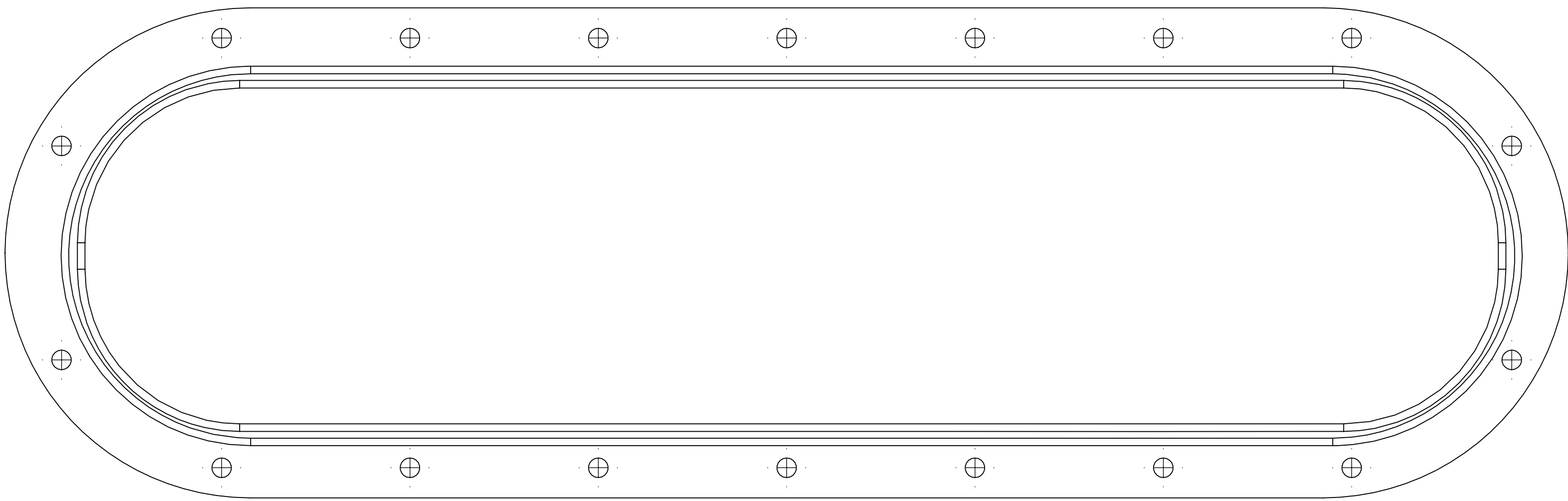

**R01SE0497/R01SE0498**

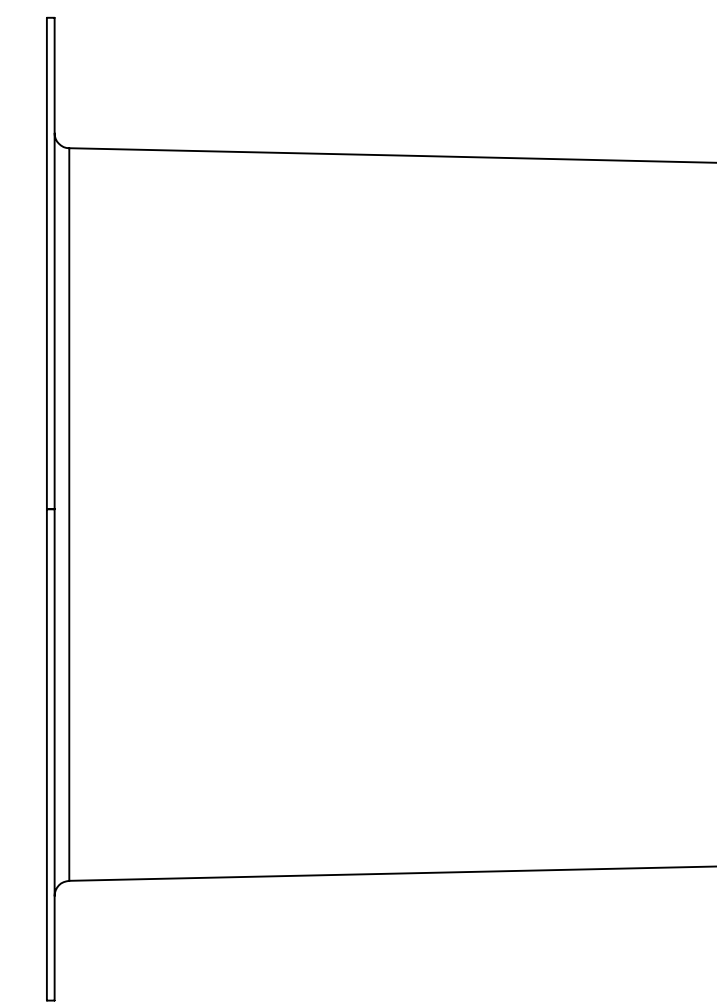
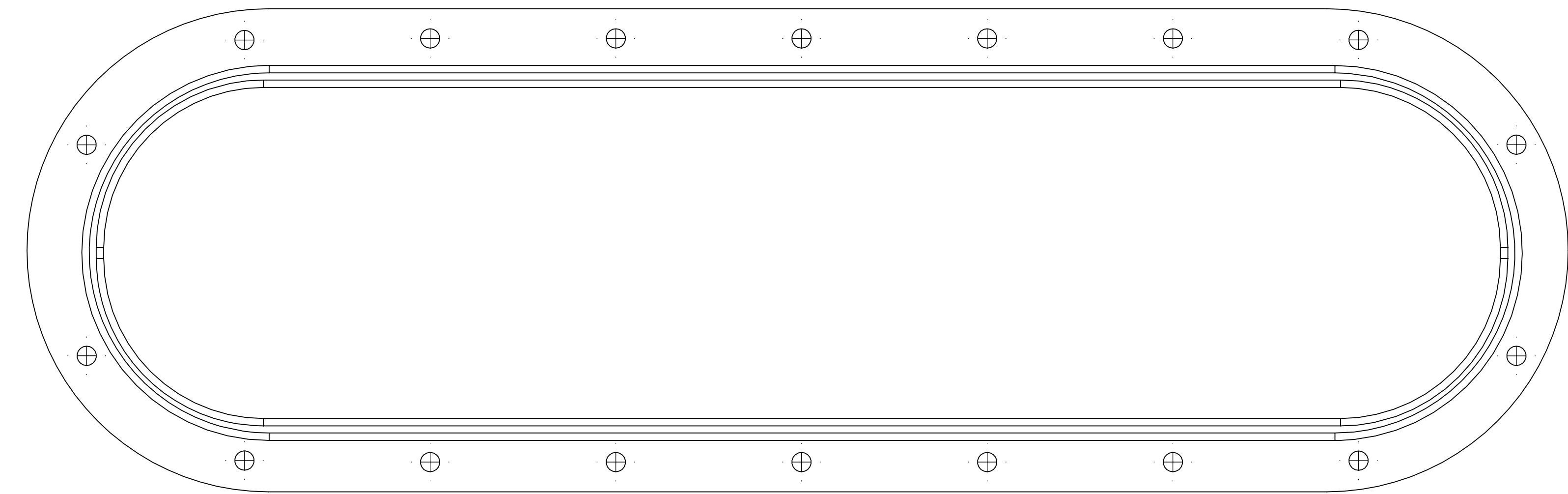
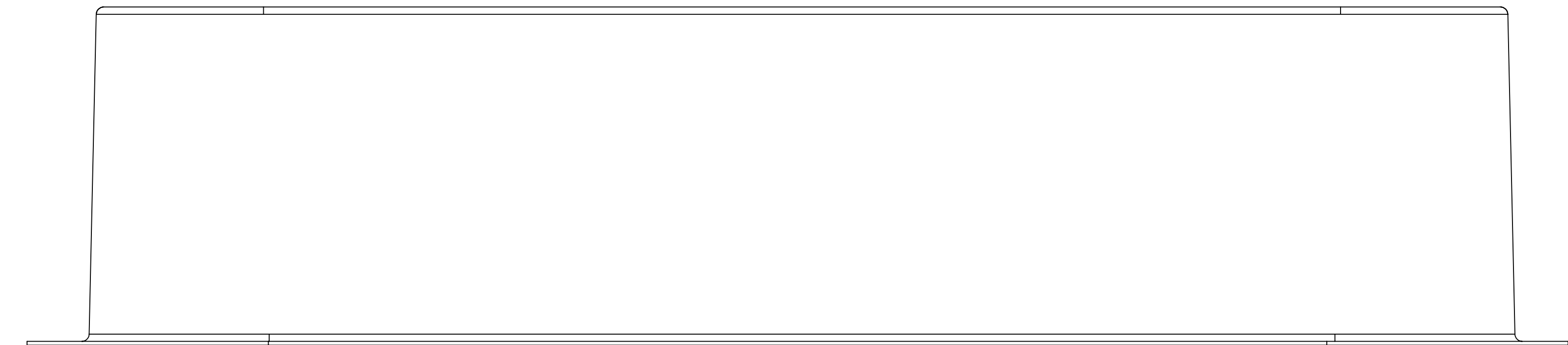

**R01SE0542/R01SE0543**

**1:1 100% SCALE**